

Series TUA

True Union, Twin Sphere Expansion Joint

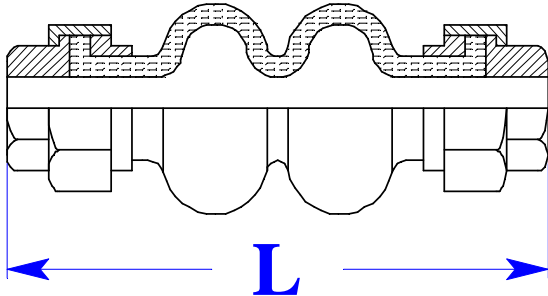

ONYX VALVE CO

Ph: 856-829-2888
 Fax: 856-829-3080

835 Industrial Hwy
 Cinnaminson NJ 08077

Standard materials of construction are Nitrile rubber with nylon reinforcement and galvanized steel End connections. End connections are NPT(F) x NPT(F).

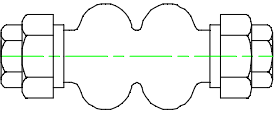
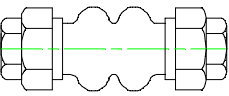
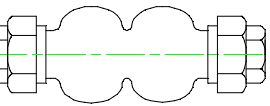
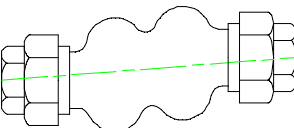
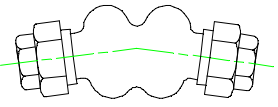
		0.7	1	1.2	1.5	2	2.5	3
 Neutral Length "L"	L	8						
	Axial Compression	0.87						
	Elongation	0.25						
	Lateral Deflection	0.87						
	Angular Deflection	±45°						
	P max	150 psi						
	P burst	710 psi						
	Vacuum	-16 inches Hg						
	Temp range	-14° to +220°F						

All dimensions are in inches.
 Specifications subject to change
 without notice.